



User's Manual

Household beauty device	Bloom Red	S10
-------------------------	-----------	-----

Table of contents

Introduction	1	After treatment	16
Safety Precautions	1	Additional information	18
When using outside of Japan	6	● Troubleshooting	18
Names and functions of components	7	● Frequently asked questions	19
Before use	9	● Product specifications	20
How to use	11	After-sales Service	21

Introduction

Thank you for purchasing YA-MAN product.

- Carefully read this User's Manual to properly and safely use the device.
- After reading the contents hereof, make sure to store this User's Manual in an accessible location.
- Make sure to include this User's Manual if you are transferring ownership of the device to another person.

Safety Precautions

- This manual provides important information to help you to use the device properly. Before using this product, please read the following contents thoroughly and carefully.
- Sensibly utilize the device in accordance with the prescribed steps.
- If an abnormality arises, immediately discontinue the use of the device and arrange to have the device repaired.
- Do not utilize the device in a defective state as doing so could cause physical harm to the user.
- Precautions listed in the User's Manual are very important. For your safety, please follow them carefully.
- In order to expressly indicate the magnitude of the hazard and harm that could be caused and the degree of urgency applicable to each case, precautions have been classified as follows according to the foreseeable outcomes of a failure to properly operate the device: Danger, Warning, and Attention.

● Classifications of precautions



Danger

By failing to properly operate the device according to this type of precaution, it is expected that a hazard that could cause the death or serious injury of an individual will imminently arise.



Warning

By failing to properly operate the device according to this type of precaution, a hazard that could cause the death or serious injury of an individual might conceivably arise.



Attention

The failure to properly operate the device according to this type of precaution could conceivably cause an injury to an individual or property damage (*) to occur.

Property damage refers to expanded damage affecting a dwelling, household belongings, or domestic animals and pets.

● Symbols



This symbol shows you what you must not do.



This symbol shows you what you must do.



Indicates that a precautionary point must be expressed for the matter in question.

Danger (regarding use and storage)

- Do not use the device under any of the following conditions.

Use of the device could cause an electronic medical device to malfunction.

◆ Persons using electronic medical devices.

- Pacemaker or other implanted electronic medical device; Artificial heart-lung machine or other electronic life-support medical device; Electrocardiograph or other worn electronic medical device.



Prohibited

Warning (regarding use and storage)

- The following persons should not utilize the device.

May cause an accident or other problems.

- Those undergoing treatment by a doctor, those in a physical growth stage, those with acute medical conditions, tubercular conditions, fever, high blood pressure, communicable diseases, malignant tumors, blood diseases;
- Those with diseases of internal organs, skin conditions, allergies, atopic dermatitis, skin conditions, or sensitive or weak skin;
- Those with pathological marks on the skin due to physical stimulus or other causes, those with painful or inflamed skin due to sunburn;
- Those experiencing severe fatigue, those in poor health, intoxicated persons, pregnant women, women during their period, or breastfeeding mothers, those taking medications that cause drowsiness;
- A person who is a long-term user of a steroid-based hormonal drug or who suffers from telangiectasia due to an impairment of liver function.
- Those who had an operation on their eye(s) or faces; who have a disease of the eye(s) or face; those who are currently undergoing treatment for a disease of the eye(s) or face.
- Those with excessive myopia (-6D or higher).



Prohibited

- Do not use the device on various sites as indicated below and outside of specified sites on the face.

May cause an accident or other problems.

- Body parts with cuts or that have undergone cosmetic surgery, inside the mouth, in the pubic region, or on mucous membranes, parts inflamed due to acne or skin infection, parts that feel itchy or burning
- Swollen moles, viral warts, on the Adam's apple, on the eyeballs, eyelids, or around the eyes

*If you are uncertain as to whether it is safe to use the device, consult a physician prior to use.

- Do not use continuously on the same body part. Be sure to move the device across the skin while using it.
Do not use on body parts that cannot be reached by the entire head surface.

May cause a burn injury or a low-temperature burn injury

Warning (regarding use and storage)

- Keep the device, AC adapter, and USB cable away from water. (Do not apply water to or wash the device in water.)

Also, do not use near water, in the bathroom, or while bathing.

May cause an electric shock, short circuit, or fire.



Do not use near water

- Do not use the device for any purpose other than those stated in the User's Manual.

May cause injury or malfunction.



Non-intended uses prohibited

- Do not place the device near fire or flame, or dispose of in a fire. Do not use, charge, or store in a high temperature area or if the device is hot.

The device features a built-in rechargeable battery. May generate heat, ignite, or explode.



Prohibited

- Do not disassemble, repair, or modify the device yourself.

May cause a fire, electric shock or injury. Contact your local distributor for advice on repairing the device.



Disassembly prohibited

- Do not use the device near a flammable substance (such as alcohol, thinner, benzene, nail polish remover, or spray).

May cause a fire, electric shock or injury.

- If any problem occurs during use, including abnormal odor or excess heat, turn off the power.

May cause the device to become damaged or to ignite.



Prohibition against use when an odor or abnormal generation of heat is detected

- Keep away from children and do not allow children to use the device.

May cause an accident or injury.



User restrictions

- Do not allow persons who are unable to express their intentions on their own to use the device. Use by unattended persons with physical disabilities should be avoided.

May cause an accident or injury.

- Do not leave in hot or humid places, such as near flame, in bright sunlight, or in a bathroom.

Do not bring the device close to a heater.

May generate heat, ignite, or explode.



Combustion warning

Attention (regarding use and storage)

- Do not use continuously for more than six minutes.
May cause skin problems.

- Refrain from the following acts.

May cause an accident, injury, or a failure of the device.

- Do not use the device if your skin is experiencing a rash, inflammation, itchiness, or other abnormalities.
- Do not use if damaged due to dropping or impact with another item.
- Do not use continuously for an overly long period (for example, through commercial use).

- Do not wipe the device with alcohol, thinner, benzene, nail polish remover, or other such substance.

May cause damage to the surface of the device.

- Avoid contact between the probe head and metal surfaces.

May cause a failure of the device or injury.

- Do not use the device on pets.

May cause an injury.



Prohibited

- Do not place the device in an unstable location. Do not drop or strike the device.

May cause a failure of the device. An injury may also be caused if the device is dropped on a foot or other exposed body part.



Dropping prohibited

- Be sure to comply with the following items.

May cause an accident, injury, or a failure of the device.

- Do not use continuously on the same body part.
 - Use the device appropriately based on your skin conditions.
 - After sunbathing, do not use the device in combination with peeling, skin packs, or other treatments.
 - Be sure to turn the device off after use.
- Stop using if you feel any physical discomfort during use.
If you notice anything unusual about your skin during or after use, stop use and consult a doctor.
 - Use only Level 1 upon first use and until you are accustomed to use.
May cause an accident or injury.



Must comply

Warnings (regarding the power supply)

- Use the included AC adapter and USB cable with this product. Directly plug the AC adapter into a wall outlet and Do not overload an electric circuit.
May cause an electric shock, short circuit, or fire.



- When unplugging the AC adapter or USB cable from the unit or a power outlet, do so by gripping the plug. Do not insert or disconnect the plug with wet hands.
May cause an electric shock, short circuit, or fire.



- Do not cut, damage, modify, excessively bend, pull, twist, or wrap the AC adapter or the USB cable.
Placing a heavy item on top of the AC adapter or USB cable, or pinching them between other items, could damage them and cause fire or electric shock.

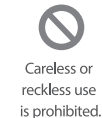

- Unplug the AC adapter and USB cable when not in use. Do not insert or disconnect the plug with wet hands.
May cause an electric shock, short circuit, or fire.



- Do not use if the AC adapter or USB cable is damaged or the wall socket is loose.
May cause an electric shock, short circuit, or fire.
Contact the seller from which you purchased the device for advice on repairing the device.



- In the unlikely event that an abnormality arises, immediately unplug the AC adapter and USB cable.
Do not use the device if smoke, an abnormal noise, or an odor is detected or if it is otherwise operating in an abnormal state.

Warnings (regarding the power supply)

- Before charging the device, check to make sure that the charging terminal and USB cable are not wet.
May cause an electric shock, short circuit, or fire.
- Be sure to turn the power off and unplug the USB cable from the unit when not in use and during care.
May cause an electric shock, short circuit, or fire.
- Use in an operating voltage range from 100 to 240 volts. (Free repairs only in Japan)
Make sure that the AC adapter and USB cable are fully inserted into an electrical outlet.
May cause a fire, electric shock or injury.



Must comply

When using outside of Japan

WARNING

- Be sure to use in an operating voltage range from 100 to 240 volts. (Free repairs only in Japan)
May cause a fire, electric shock, or a failure of the device.
- Be sure to check the plug shape and the voltage of the power outlet before using.
May cause the generation of heat or a fire or failure of the device.



Must comply



Combustion
warning

- Use a power plug adapter (not included) for outlets with shapes that differ from those in which the enclosed power adapter plug can fit.
- The plug shape and voltage may differ depending on region and trip destination. Use the device after verifying compatibility.
- For information about plug adapters, consult a travel agency or a consumer electronics retailer.

Names and functions of components

Main unit

● Front

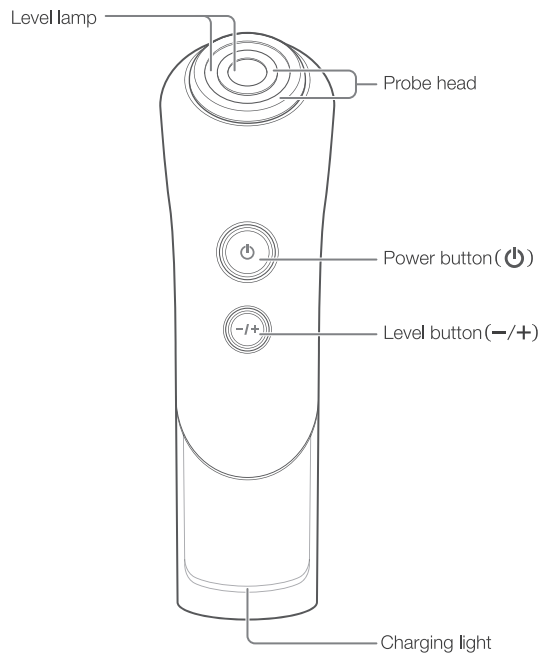

● Rear

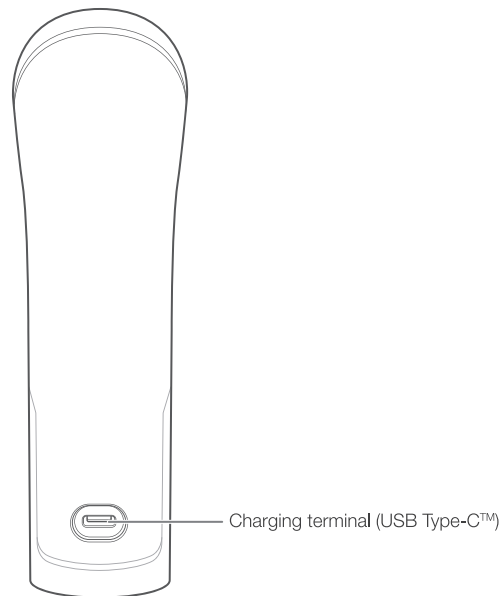

Accessory

- AC adapter
- USB cable (USB Type-C™)
- Flawless gel
- User's Manual

The design and specifications of the device and peripheral accessories are subject to change for improvement purposes without notice.

• USB Type-C™ and USB-C™ are trademarks of the USB Implementers Forum.

Functions

Safety functions

- Temperature sensor
Reduces output for safety reasons when the temperature on the skin or the probe head rises.
Also, turns the power off when the temperature rises excessively. (The level lamp will flash and the buzzer will sound five times as an indicator)
When this happens, let the device rest for about 30 minutes.
- Motion sensor
Detects movement of the device and reduces output for safety reasons when the probe head has been used in the same place continuously.
When movement of the device slows, the motion sensor may reduce the level of warmth.

Auto Power Off

The device will automatically switch OFF approx. 6 minutes after it has been turned ON ("beep beep").

Alert timer

Try to use the device for about six minutes on the entire face. A buzzer will sound ("beep beep beep") after three minutes.

Battery charge indicator

The device will notify you about the low battery condition when you turn it on (the level lamp will flash and buzzer will sound 6 times). It is recommended to charge the device after it is operated for 6 minutes. Unless the device is fully charged or being charged for more than 40 minutes, the beeping sounds and flashing lights will continue to occur when you turn on the device again .

Before use

Charge the unit

Using a household power outlet

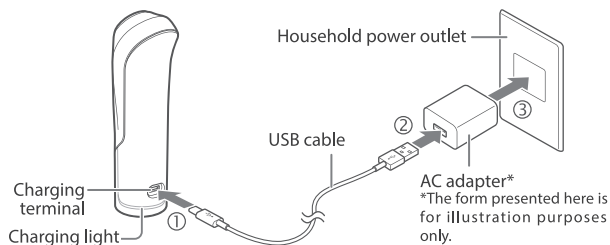

Using a computer

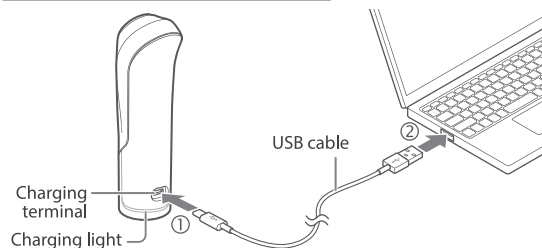

- While charging, the charging light on the bottom of the device will blink.
 - When charging is complete, the charging light on the bottom of the device will blink for five seconds and then turn off. Remove the AC adapter and USB cable.
 - At an indoor temperature of approximately 25°C, it will take about three hours to reach a full charge, at which the device can operate for about 20 minutes. Actual charging time and operating time will differ depending upon the remaining power and the charging environment.
- *If charging has not begun after about 10 seconds, check whether the USB cable or the AC adapter is loose.

Attention

- If there is any moisture on or around the main unit and charging terminal, be sure to wipe dry. Charging while moist could cause damage.
- When charging the battery for the first time after purchasing the device, use the device only after the battery is fully charged.
- When using the device for the first time or when the device has not been used for an extended period of time, it is possible that you will be unable to use the device for very long even with a full charge displayed. In such a case, charge the device again before using it.
- Use only the enclosed USB cable and AC adapter.

*In some cases, the unit might not charge properly if using a generic cable or AC adapter.

Pre-testing on skin

When using the device for the first time, always test for compatibility.



Attention

- Make sure to perform a pre-test in order to prevent skin problems from occurring.
- If a rash, reddening, itch, stinging sensation, or other abnormality occurs at the pre-testing site, immediately stop the pre-test.
- Do not use the device if a skin abnormality is perceived.

1

Wash your inner arm with soap and water and wipe dry with a towel.

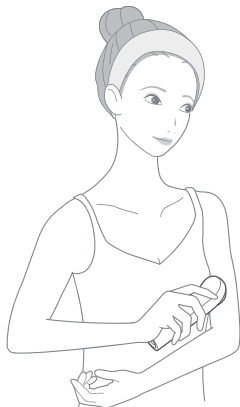

2

Apply the Flawless gel (about one large pearl-sized drop) to the center of the probe head, turn the power on, and then use the unit for about three minutes while moving it across the skin (page. 11).

Be sure to test at Level 1.

3

Rub the Flawless gel left on your face and make sure that there is nothing unusual about your skin.

Continue to use the product only if you experience no reddening or burning sensation in your skin within 24 hours.

How to hold the device and use on your skin.

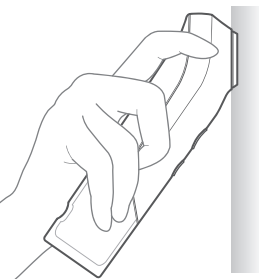

Hold the unit as shown below, moving it slowly so that the entire probe head remains in contact with your skin.

- Be sure to move the unit while using it, with the entire probe head in contact with your skin.

How to use

Basic method of use

Make sure to remove makeup and wash your face before using the device.

1 Turn on the device

The Level 1 lamp will light up.

*For safety reasons, the device is set to Level 1 when turned on.

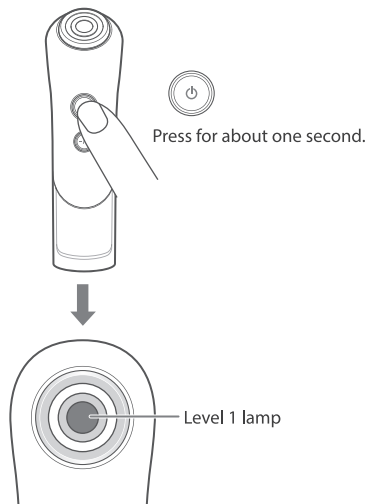

2 Select the level

Each time the level button (-/+) is pressed, levels can be adjusted. You can use the level lamp to check the level.

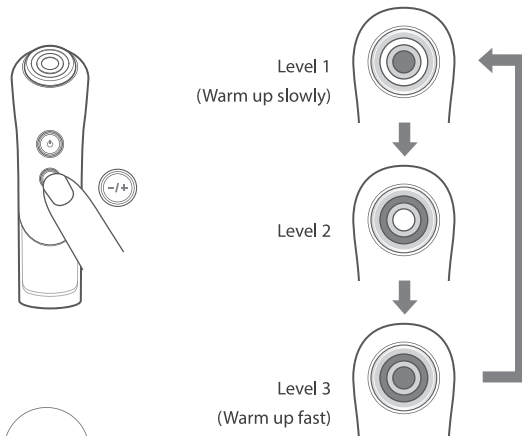

Attention

Use only Level 1 upon first use and until you are accustomed to use.

3

Apply the Flawless gel to the center of the probe head and then apply the probe head to the skin and activate it.

Care for your face in six areas (pages 13-14).

Apply one large pearl-sized drop of Flawless gel for each area.

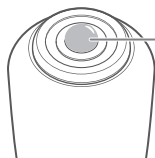

Flawless gel
(About one large
pearl-sized drop)



See "Moving the Unit" (pages 13-14) for
how to move the unit.

Attention

- Do not apply the Flawless gel with your hand. Doing so could soil the unit or cause it to slip and fall.
- If the unit does not move smoothly while using it, apply more Flawless gel.
- Use in a position in which the entire surface of the probe head comes into contact with your skin.
- Be sure to move the unit on your skin while using it.
- If it feels too hot, move it a little more quickly or lower the level.

4

Care for the skin when complete

When complete, care for the skin using the cosmetics that you use every day.

- Do not use on the Adam's apple, the eyelids, or around the eyes



Moving the unit

Move the unit in the directions of the arrows in order from ① to ⑧ below. Repeat the movement three times for each arrow.

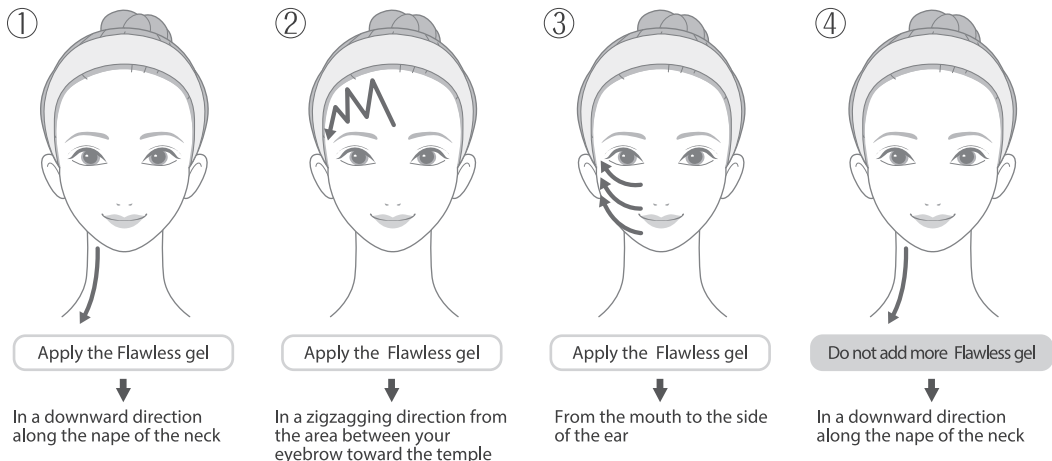

Left side **Approx. 3 minutes**

- Recommended speed of moving the unit: 4 cm/second
- Recommended duration of use: about six minutes/use (on entire face)
- A buzzer will beep after three minutes. Use it as a rough indicator of time used.
- If you want to stop the treatment during use, press the power button  for at least one second to turn off the power to the unit.

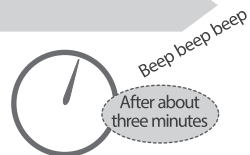

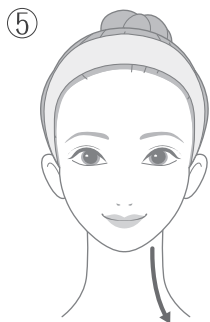

Apply the Flawless gel

In a downward direction
along the nape of the neck



Apply the Flawless gel

In a zigzagging direction from
the area between your
eyebrow toward the temple



Apply the Flawless gel

From the mouth to the
side of the ear

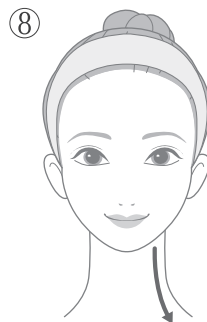

Do not add more Flawless gel

In a downward direction
along the nape of the neck

Right side

Approx. 3 minutes

Power
turns off
automatically

⚠ Attention

- Do not use continuously for more than six minutes
May cause skin problems.

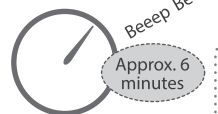

The device will
automatically
switch OFF approx.
6 minutes after it
has been turned
ON.

Treatment tips

Use as described below for more effective results in areas of concern.

Around the mouth

Move the unit three times in the directions of the arrows below.



Apply the Flawless gel



In an upward direction along the smile lines, toward the temple (three times)

Chin - face line

Move in the directions of the arrows three times each in order from ① to ③ as shown below.

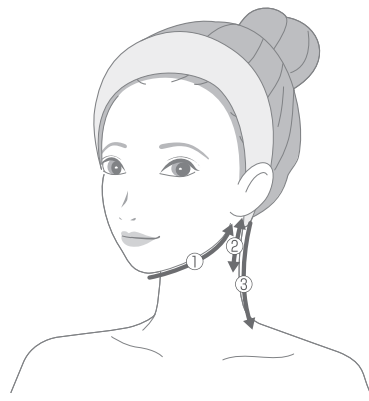

Apply the Flawless gel



- ① From the tip of the chin to below the ears (three times)
- ② Back and forth below the ears (three times)
- ③ From top to bottom along the nape of the neck (three times)

After treatment

How to clean

Clean the device after each use.

Warning

- When cleaning the device, make sure to turn it off and disconnect the USB cable from the main unit.
May cause an electric shock, short circuit, or fire.

- Do not wash in water
This device is not waterproof. May result in a failure of the device.

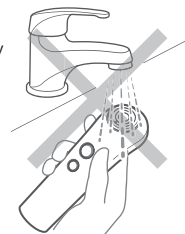

1

Wipe off any soiling using a well-wrung soft cloth or similar material.

- For stubborn soiling, wipe gently with a cloth soaked in a diluted neutral detergent.

Attention

- Do not leave the unit with Flawless gel on it.
- Refrain from using an alkali cleaning agent, alcohol, thinner, benzene, nail polish remover, or other such substance.



Storing

- Store in a clean, well-ventilated place out of the reach of children.
- Remove the AC adapter and USB cable from the unit and the power outlet when not in use for a long time.
- Do not leave in hot or humid places, such as near flame, in bright sunlight, or in a bathroom.

Maintenance and inspections

- If you have not used the device for an extended period, inspect it carefully and check that the device works properly and safely before use.
- If the device is malfunctioning, go to "Troubleshooting" (page 18) and attempt to identify the problem before arranging to have the device repaired.
- If the device is malfunctioning or damaged, contact the seller from which you purchased the device for advice on repairing the device.

Additional information

Troubleshooting

If you perceive an abnormality while using the device, verify the following points before arranging to have the device repaired.

Symptom	Possible causes and solutions
Does not turn on	→ Press the power button (⏻) for about one second.
	→ Run out of power. Charge the battery (page 9).
Device only operates for a few minutes even after charging.	→ The power turns off automatically after about six minutes.
	→ Low battery. Charge the battery (page 9).
	→ Battery life ended. Contact local distributor. (Do not try to replace yourself as this may cause malfunction.)
Unit does not start charging.	→ Insert the enclosed USB cable into the unit (page 9). Check to make sure that the cable is not loose.
	→ Connect the AC adapter to a wall outlet (page 9).
	→ Turn on the power to the computer (page 9).
	→ Reset the unit by pressing the power button (⏻) and the level button (−/+) simultaneously. Sometimes this will start the charging cycle.
The radio frequency (RF) feels too hot	→ The unit has been applied to the same part for too long. Be sure to keep the roller moving over the skin during operation.
	→ Move the device a little more quickly.
	→ Lower the level. Be sure to use Level 1 on first use.
The radio frequency (RF) does not feel warm.	→ Your skin is dry. Moisturize your skin by applying the Flawless gel.
	→ Raise the level.

Frequently asked questions

Q What is the recommended duration and frequency of use?

A

Try to use five days a week (once daily, up to six minutes).

*You may increase or decrease the frequency of use with reference to your skin's condition.

*If you perceive a skin abnormality, immediately stop using the device.

Q Can I use the device constantly?

A

We recommend using this device once a day, for six minutes.

Q How much Flawless gel should I use each time?

A

Use about six large pearl-sized drops for the entire face.

We recommend adding more Flawless gel if it feels like there is not enough.

Q Can I use the device in the bathroom?

A

This device is not waterproof. Do not use the device in the bathroom.

Q My skin is flush after use.

A

This is due to the heat of the radio frequency (RF).

Q The probe head does not warm up.

A

The radio frequency (RF) does not warm the probe head. Rather, it uses the power of electricity to warm your skin.

Q Is there any difference in its effectiveness when you change RF level?

A

As you increase RF level, it will be stronger and the device will become warm faster.

Product specifications

Rated power supply	DC5V 2.0A
Power consumption	Approx. 4.5 W (when charging)
Battery	Lithium ion battery
Charging time	Approx. 3 hours *May vary depending on the charging environment.
Operating time	Approx. 20 min. (when fully charged) *Operating time may vary with conditions of use and level.
Outside dimensions	Approx. W47 × D45 × H154 (mm)
Weight	Approx. 175 g
Materials	Main body: ABS resin, polycarbonate Probe head: Stainless steel
Country of origin	Japan
Accessory	AC adapter One USB Cable (Type-C™) One Flawless gel One User's Manual
Recommended environmental temperature	10 °C ~ 40 °C

After-sales Service

Rechargeable battery

- The rechargeable battery is a consumable item. (not covered by the product warranty).
- If the device no longer operates for more than a short period of time even after the battery has been recharged, the battery may have reached the end of its service life. (The battery is expected to last 300 charge cycles.)
- If you need a battery replacement, contact your local distributor. The battery is not user-replaceable.

Disposing of the device

- If you wish to dispose of the device, proceed in accordance with applicable local government rules governing the sorting of waste products.
- This product uses a lithium ion battery.



Contacts for overseas customers

For countries and regions outside Japan, please contact the store where you have purchased your product for any inquiry about it. Alternatively visit YA-MAN Global Official Website (<https://www.ya-man.com/en/>).

Recommended cosmetics

Flawless Gel

Weights : 80g

Product code : CS17006

Price : JPY3,500

(Excluding tax)

Weights : 200g

Product code : CS18002

Price : JPY6,000

(Excluding tax)

.....
*We may terminate sales of this product
without prior notice.

